

- ECHO SOUNDER
- FISHING : NAVIGATION : SURVEYING
- 6 FREQUENCY OPTIONS
- NEPTCAST® PU MOULDED
- HULL OR OVER-SIDE MOUNTING
- LOW COST

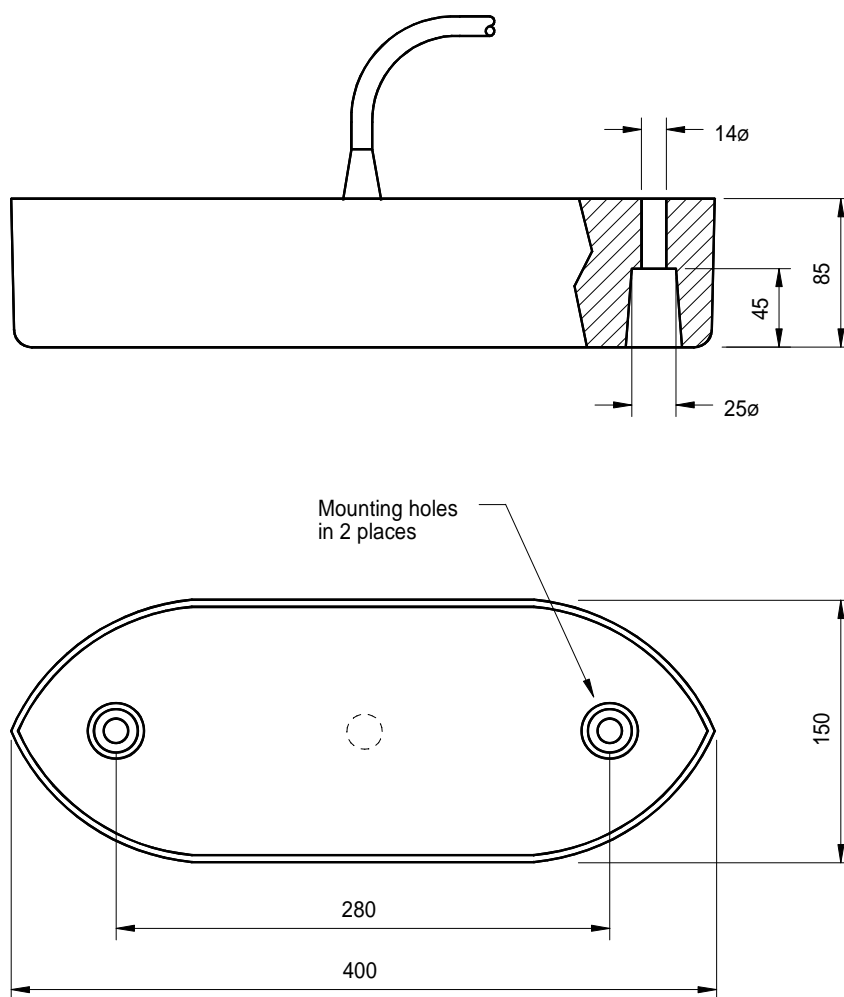

The 320 SERIES continues the company's successful policy of providing a range of frequencies in the same transducer shape. Compatible with a wide range of echo-sounders the piston elements are configured to achieve optimum echo-sounder performance.

The NEPTCAST® over-moulded polyurethane housing provides a mechanically robust, corrosion free transducer for hull or over-side mounting, offering maximum flexibility at minimum cost.



All dimensions in mm

MODEL 320 SERIES

Single Beam Transducers

Technical Specification

Frequency Options	24	28	30	33	38	50	kHz
Beam Angle (-3dB)	19 x 34	16 x 30	15 x 27	14 x 25	12 x 22	16 x 16	Degrees
Transmit Sensitivity	166	167	167	166	165	166	dB re uPa/V @ 1m
Receive Sensitivity	-164	-166	-167	-168	-169	-178	dB re V/uPa
Input Power	900	900	900	900	900	900	Watts
Bandwidth	2.8	3.5	3.0	3.5	3.5	5.0	kHz
Nominal Impedance	75	75	100	100	100	75	Ohms

Transducer impedance can be adjusted to suit customers specification

Cable Length	10 Metres Standard (Additional lengths supplied to order)
Cable Type	Polyurethane Ø12mm 2 Core Screened
Storage Temperature	-40 to +80 °C
Operating Temperature	-5 to +70 °C

Data illustrated is taken from actual in-water measurements